

LEADING THE WAY

# Dedication & Recognition Opportunities



# the time is now...

There has never been a more critical moment to invest in the future of Central High School, to support all that we foster—engaged students, invested faculty, rigor and academic excellence, commitment to community service, and social good.

*Leading The Way for Innovation and Creativity* supports our mission to provide a transformative educational experience for our students and create a lasting legacy of excellence.

Your help is needed to repair and invigorate the campus, deliver academic richness, advance the performing arts, provide 21st century learning opportunities, integrate STEM education and create a Central Fund for the Future.



Performing  
Arts Theater



Art Gallery &  
Student Entry



Campus,  
Plaza, Bridge

“I know that many Central High School graduates look back and realize how Central helped to prepare them for their careers. My hope is that many will choose to give back to Central to help fulfill the dream; I have agreed to arrange for them to be matched up to a total of \$10 million.”

*Joseph Field, 192*



Music  
Rehearsal Hall

The following dedication opportunities are provided for those wishing to be recognized as major donors to the Capital Campaign. Permanent donor recognition will be located in the Performing Arts Center.

We have outgrown the close confines of small spaces devoted to the arts. The Performing Arts Center will provide us with new and exciting experiences to flourish.

*Grace, 277*



<i>Performing Arts Center</i>	\$10,000,000
<i>Performing Arts Theater</i>	\$5,000,000
<i>Theater Stage</i>	\$3,500,000
<i>Theater Lobby</i>	\$3,000,000
<i>Plaza Bridge</i>	\$2,500,000
<i>Plaza Art Gallery</i>	\$2,000,000
<i>Grand Outdoor Plaza</i>	\$2,000,000
<i>Plaza Entrance to Theater</i>	\$1,500,000
<i>Theater Scene Shop</i>	\$1,500,000
<i>Music Technology Lab</i>	\$1,500,000
<i>Music Rehearsal Hall</i>	\$1,000,000
<i>Technical Catwalk</i>	\$1,000,000
<i>Parking Entrance to Theater</i>	\$1,000,000

<i>Ensemble Studio</i>	\$500,000
<i>Control Room</i>	\$250,000
<i>Costume Shop</i>	\$250,000
<i>Dressing Room, W</i>	\$250,000
<i>Dressing Room, M</i>	\$250,000
<i>Stage Office</i>	\$150,000
<i>Music Office 1</i>	\$100,000
<i>Music Office 2</i>	\$100,000
<i>Practice Studios</i>	\$75,000
<i>Theater Restroom(s)</i>	\$75,000
<i>Audience Chair (loose)</i>	\$10,000
<i>House Seating (adjustable)</i>	\$5,000
<i>Balcony First Tier Seats</i>	\$2,500
<i>Balcony Second Tier Seats</i>	\$2,500

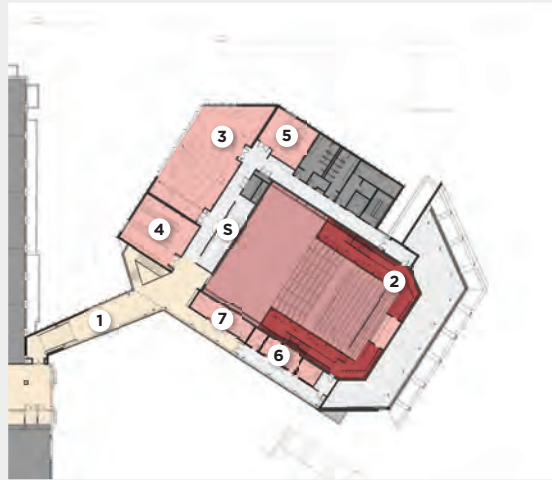

## Second Floor

- 1 Plaza Bridge
- 2 Balcony
- 3 Music Rehearsal Hall
- 4 Music Technology Lab
- 5 Ensemble Studio
- 6 Practice Studios
- 7 Music Offices

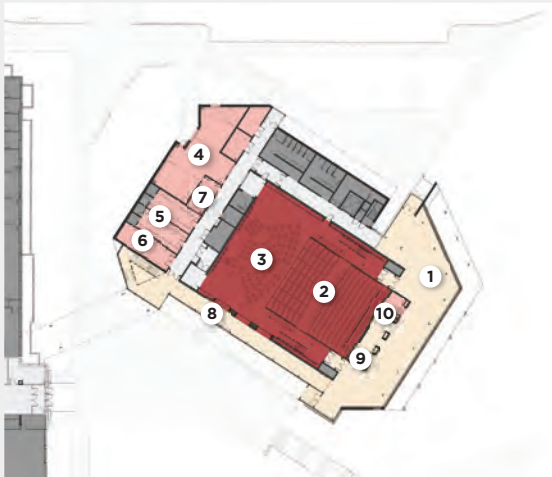

## First Floor

- 1 Theater Lobby
- 2 Theater House
- 3 Theater Stage
- 4 Theater Scene Shop
- 5 Dressing Rooms
- 6 Costume Shop
- 7 Stage Office
- 9 Plaza Art Gallery
- 10 Lobby Art Gallery
- 11 Box Office

